



## DeltaTherm® HIU

RESOL offers individual solutions for the control of OEM heat interface units.

The *DeltaTherm®* HIU is a controller for heat interface units and can be used for heating circuit control as well as for DHW heating.

The controller concept enables adaptation to the individual requirements. The graphic menu and pre-programmed functions ensure high operating comfort.

RESOL develop and produce the right OEM controller to meet your requirements, CONTACT US!

## Controller concept for heat interface units

- Heating circuit control with DHW exchange switchover
- Return limitation, night correction, summer operation, etc.
- DHW with standby function
- Weather-compensated control or demand-based room control
- Control of PWM pumps and valves
- Adaptable to many commonly used flow rate sensors
- Remote access with a room control unit
- Data logging and firmware updates via SD card

Article no.	Article	Price bracket
	DeltaTherm® HIU – Controller for OEM heat interface units	A

## APPLICATION EXAMPLE

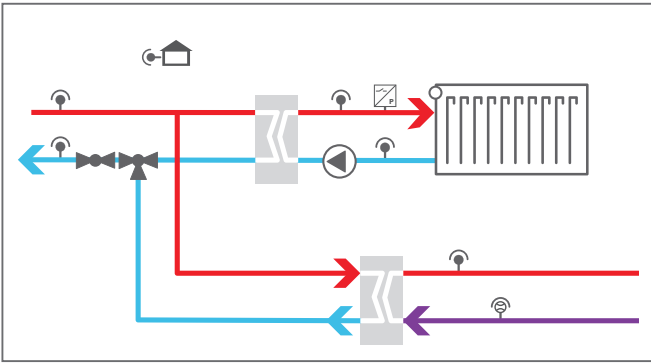

## TECHNICAL DATA

**Inputs:** 10 Pt1000 temperature sensors, 1 flow rate sensor

**Outputs:** 4 electromechanical relays, 3 PWM outputs

**PWM frequency:** 1024 Hz

**PWM voltage:** 11.2 V

**Switching capacity:** 1 (1) A 240 V~ (electromechanical relay)

**Total switching capacity:** 4 A 240 V~

**Power supply:** 100 – 240 V~ (50–60 Hz)

**Supply connection:** type X attachment

**Standby:** < 1 W

**Temperature controls class:** V

**Energy efficiency contribution:** 3 %

**Data interface:** VBus®, SD card slot

**Overvoltage category:** 2

**VBus® current supply:** 60 mA

**Mode of operation:** type 1.B action

**Housing:** plastic, PC-ABS and PMMA

**Mounting:** integrated into the station

**Indication/Display:** full graphic display, operating control LED (directional pad) and background illumination

**Operation:** 7 buttons

**Ingress protection:** IP 20/EN 60529

**Protection class:** I

**Ambient temperature:** 0 ... 40 °C

**Degree of pollution:** 2

**Relative humidity:** 10 ... 90 %

**Fuse:** T4A

**Maximum altitude:** 2000 m above MSL

**Dimensions:** 198 x 170 x 43 mm

## ACCESSORIES

### DL2 Plus Datalogger



For remote access to 2 controllers, integrated data logging and connection to a BMS

(see page 81)

### KM2 Communication module



For remote access to the controller via VBus.net

(see page 80)

### VBus®/LAN interface adapter



Network connection set for RESOL controllers with VBus® incl. Service CD

(see page 83)

### RTA12 Remote control



The heating curve can be comfortably adjusted from the living area

(see page 108)

### RCP12 Room control unit



The heating curve can be comfortably adjusted, incl. operating mode switch

(see page 108)

### Central outdoor sensor unit



Measures the outdoor temperature and transmits this value to the controllers connected

(see page 109)